

Proposed Geothermal Logistical Site Plan ~~END DATE~~ **END DATE FEB 25<sup>TH</sup>**

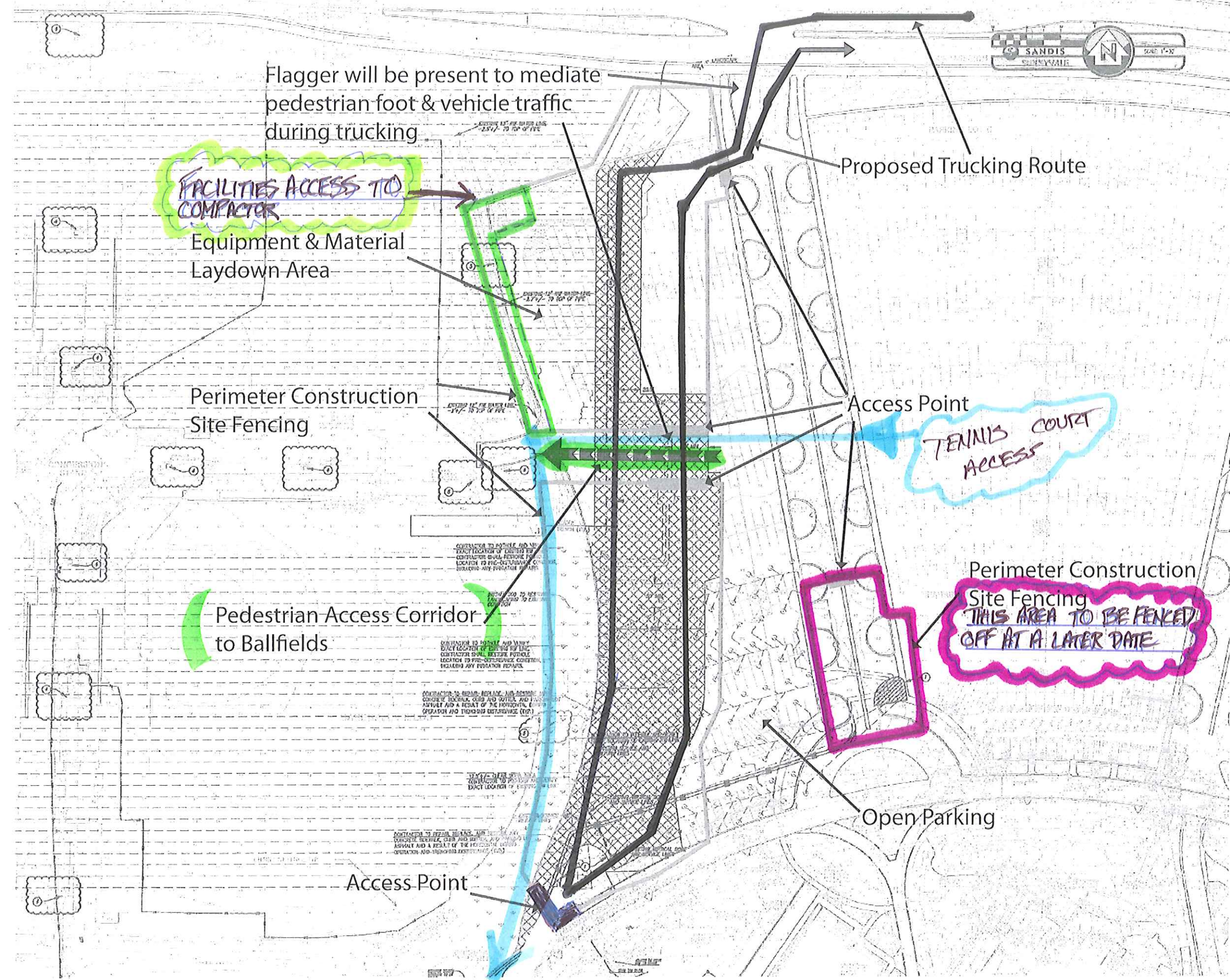

Flagger will be present to mediate pedestrian foot & vehicle traffic during trucking

**FACILITIES ACCESS TO COMPACTOR**  
Equipment & Material Laydown Area

Proposed Trucking Route

Perimeter Construction Site Fencing

Access Point

**TENNIS COURT ACCESS**

Pedestrian Access Corridor to Ballfields

Perimeter Construction Site Fencing  
**THIS AREA TO BE FENCED OFF AT A LATER DATE**

Open Parking

Access Point

